



Before using your washing machine, please read this manual carefully and keep it for future reference.

## **Full Automatic Electric Washing Machine**

### **OWNER'S MANUAL**

#### **BWM55**

#### **Read This Manual**

Inside you will find many helpful hints on how to use and maintain your washing machine properly. Just a little preventative care on your part can save you a great deal of time and money over the life of your washing machine. You'll find many answers to common problems in the chart of malfunction display and solutions. If you review the chart of malfunction display and solutions first, you may not need to call for service.

Contents

Safety and precautions..... 2

Installation of the washer..... 5

Preparation before washing..... 7

Parts identification of the washer..... 8

Instruction of the washer operation panel..... 9

Quick start..... 11

The main wash..... 12

Special features..... 13

About the procedure of full automatic wash program..... 15



Cleaning and Maintenance of the washing machine..... 17

Identify usual trouble of washer..... 18







Malfunction display and solutions..... 19

Technical specifications..... 19

Observe the following items in order to prevent from injuring yourself, others and the damage of property:



	Warning	This indicates serious injury or death to human being may be caused.
	Caution	This will remind you that injury to people and damage to property may occur.

Please observe following contents of graphics.

	This graphics represents(cause attention), and detailed cautions will be displayed inside the graphics. 
	This graphics represents (operation prohibited), and detailed prohibitive items will be displayed inside the graphics. 
	This graphic represents (forcible execution), and detailed forcible execution items will be displayed inside the graphics. 
	This appliance is not intended for use by persons (including children) with reduced physical, sensory or mental capabilities, or lack of experience and knowledge, unless they have been given supervision or instruction concerning use of the appliance by a person responsible for their safety. Children should be supervised to ensure that they do not play with the appliance.

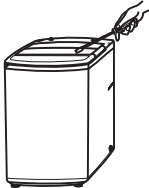

**Warning**

Please do not disassembly and assembly the machine without authorization.





No dismantling

Please do not insert your hand and take out clothes inside the spin barrel before it is fully stopped.





No touching

Please do not install the machine in damp and raining environment to avoid electric shocking, catching fire, faults and distortion accidents.



No dampness

Please do not directly rinse the machine with water when cleaning.



No rinsing



## Warning

Please do not let children climb the machine or peer into the rotating spin barrel to avoid accidents.



Prohibited

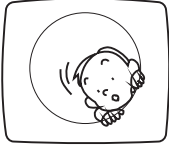

It is prohibited to wash the clothes touching with kerosene, gasoline, alcohol and other flammable materials.



Prohibited



Please do not damage power flexible cord and power plug to avoid electric shocking, short circuit and catching fire.



Prohibited

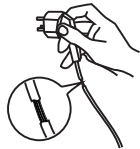

Regularly clean the power plug to remove dust and dirt to avoid contact failure.



Please pull out plug from the socket if the machine is not in use.



Pull out the plug

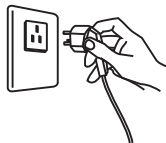

Please well connect the earth line of socket to avoid electric shocking by accidental leakage.

( earthing )



Earthing

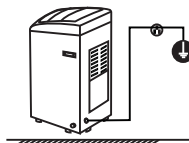

Please insert the power plug tightly.

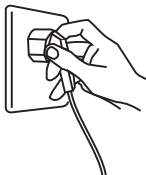

Please do not place on the washer burning candle, mosquito-repellent incense, cigarette and other flammable things, as well as electric stove, air heating fan and other heating sources.



Smoke and fire prohibited



Please use correct power source.



Please do not pull out or insert the plug with wet hands to avoid electric shocking.



Wet hands are prohibited

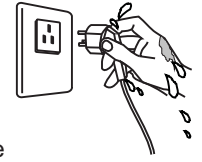

## Caution

Please ensure that the water inlet pipe is connected and the tap is opened before washing clothes.

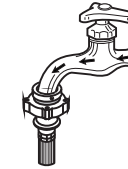

The water temperature shall not exceed 50°C when washing with warm water.



Prohibited



Customers are not allowed to change the power line without permission.



Prohibited



It is strictly prohibited to place children or lay weights on the washer.



Prohibited

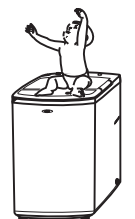

Please do not pull the electric cord when pulling out the plug.



Please do not wash down jacket, raincoat, fishing coat and similar clothes in the washer.



Prohibited



## Installation of the washer

### Remove package

- Remove package and take out the bottom board of the cabinet on the foam cover.
- Open the lid of washer's door and take out accessories.
- A trial operation or washing on the foamed cushion is strictly forbidden.

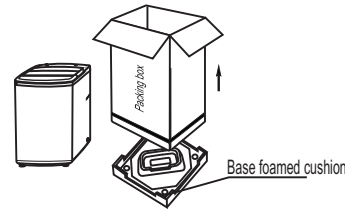

### Installation of drain hose

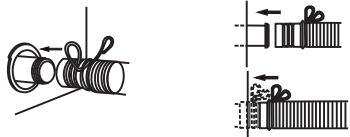

- Completely sleeve the drain hose over the sewer.
- Fix and tighten it with a hoop.  
(As shown in the figure)

### Placement of water drain hose



If the water drain hose shall be extended, its length shall not exceed 3 meters, otherwise it will affect the water discharging time.

The placed height of water drain hose shall not exceed 15cm.

Do not bend the water drain hose and place it under the washer.

FOR LOWER DRAIN SYSTEM ONLY

### Placement of upper water drain hose

- The height of drain hose ("a") should be between 86-100 cm.
- Diameter of "b" should not be less than 3 cm, and flow capacity not less than 40 L/Min.
- Before washing machine starts, user should hang up the drain pipe 86-100cm height from the floor.

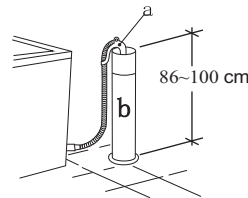

FOR UPPER DRAIN SYSTEM ONLY

### Installation of water inlet pipe

- Put the water inlet pipe(which has metallic filtering bag) screw on to the tap.
- Tightly screw another end of water inlet hose on water inlet valve .  
(with rubber seal ring inside).

Note: When tightening the clamping nut, evenly apply the force and do not twist the water inlet valve to avoid breaking of water inlet valve joint.

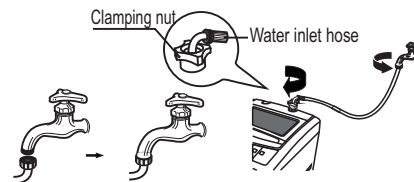

Only for model with double screw thread water inlet pipe

## Installation of the washer

### Installation of water inlet pipe

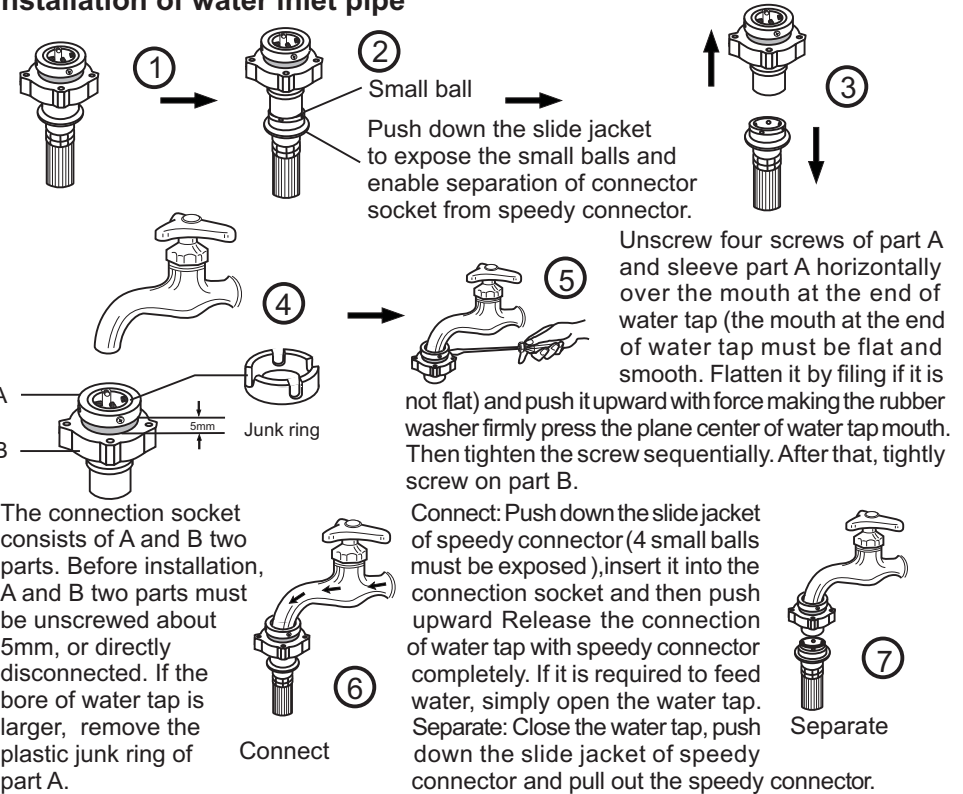

Tightly screw another end of water inlet hose on water inlet valve . (with rubber seal ring inside).  
Note: When tightening the clamping nut, evenly apply the force and do not twist the water inlet valve to avoid breaking of water inlet valve joint.

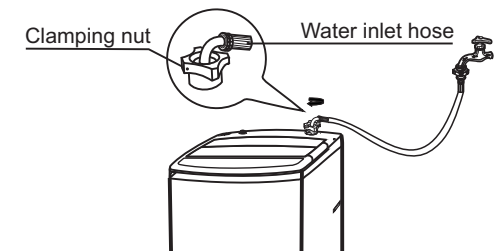

Only for model with single screw thread water inlet pipe



If the supply cord is damaged, it must be replaced by the manufacturer, its service agent or similarly qualified persons in order to avoid a hazard. **The new hose-sets supplied with the appliance are to be used and that old hose-sets should not be reused.** The openings must not be obstructed by a carpet. This appliance is for indoor use only.

## Preparation before washing

### 1 Adjust the adjustable foot to make the washer be placed stable.

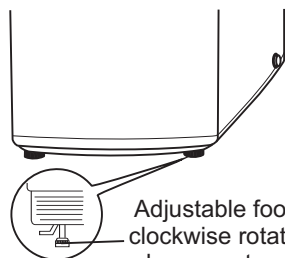

Adjustable foot (extend when clockwise rotating and shorten when counterclockwise rotating)

(Slightly incline the washer first and loosen the adjustable foot knob. Adjust the adjustable foot so as to ensure four corners of washer be steadily contacted with the ground. Then tighten the adjustable foot knob and lock it. If the ground is obviously not flat, correction should be made on the ground surface, otherwise the washer barrel will incline and knock the cabinet)

### 2 Install the water inlet hose.

For one inlet hose

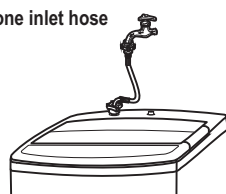

For two inlet hoses

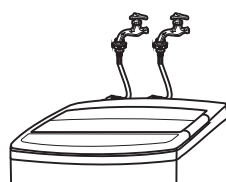

### 3 Connect with to power source.

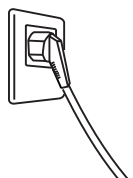

### 4 Turn on the water supply.

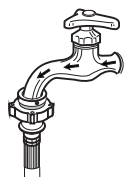

### 5 Put down the drain hose.

Gravity drain

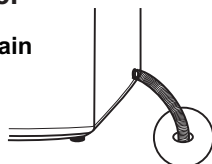

Upper drain

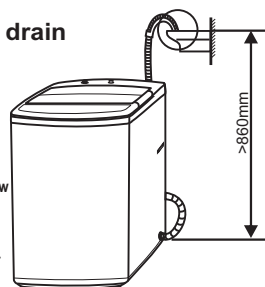

Note:  
The water will overflow when the height of the drain hose under 860mm.

### 6 Put in clothes and suitable amount of washing powder.

**NOTICE** Before washing, please do take out coins, keys and other hard goods, and zip up clothes tightly to prevent them and barrel from damage.



## Parts identification of the washer

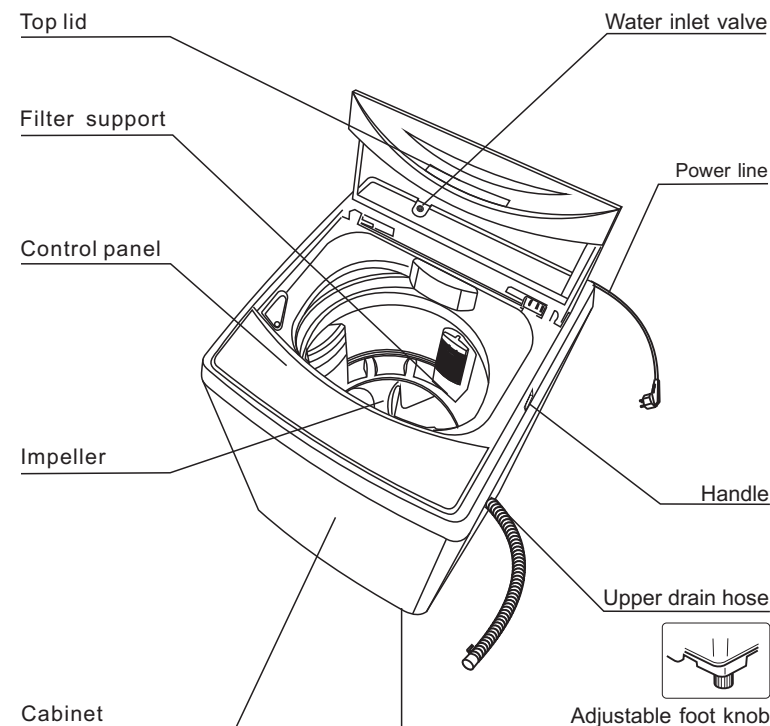

### Accessories



Universal connector

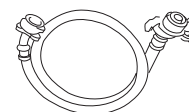

Water inlet hose assembly



Self-tapping screw

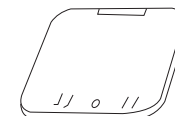

Base cover



Owner's manual

Please refer to the real material as the attachment

# Instruction of the washer operation panel

## 6.Delay

Long press "Delay" button, every 0.5s will increase 1 hour, and also have a beep once, when after reach to 24 hours, it will return to the initial state. After "delay" starts (do not press "child lock" button), consumer can review the set programs when press "delay" button again. When "delay" starts, there will be an "delay alarm" if consumer open the lid, and if consumer close the lid, this alarm will be released. But while the machine is running, if consumer open the lid, there will be no alarm. Detailed usage, consumer can refer to the description of "special function-delay function".

## 7.Program Selection

Before starting, continuously press this button to select the corresponding program: [Jeans], [Quick], [Blanket], [Delicates] Normally on; [Soaking], [Standard], [Baby Clothes], [Drum Clean] Flash.

## 8.Rinse description

This button can be responded only under the normal program, and need to have the rinsing process. Consumer can select the rinsing times and water cycle function.

## 9.Temperature

Press the button to select different temperature water for wash.

## 5.Child Lock

Press [Start/Pause] button to start the program, then press [Program] & [Rinse] button at same time to start the child lock function, it can lock the selected program to avoid any unnecessary troubles while children made the faulty operation. If consumer wants to close this function, they can re-press [Rinse] & [Program] button at the same time.

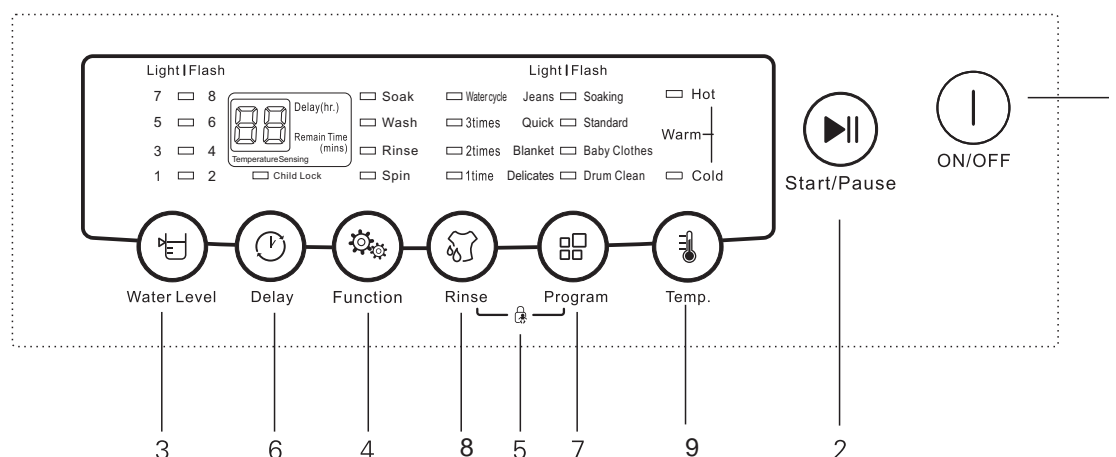

## 1.Power Supply

[ON/OFF] button has function of open or close the power supply.

## 2.Start / Pause

[Start / Pause] button has both function of start and pause. Continuously press this button, the machine will be switched between start and pause mode.

## 4.Function

After start, one light will flash among the function of soak, wash, rinse and spin according to real process.

## Three washing water levels description

"Three washing water levels" laundry concept: (suitable for the program which have soak function), the water level of "soak"/"washing"/"rinsing" will be raised in turn automatically, when soaking, it will be low water level, when washing, it will be mid water level, when rinsing, it will be high water level. If consumer select "soaking" program: the water levels selection will be 4, when running soaking, the water level only reach to the 4th level, the water level display will show 4 levels. when the program come into washing period, the water inlet will reach to the 5th level, the water level display will show 5 levels, and then run the washing process. when the program come into the rinsing period, the water inlet will reach to the 6th level, the water level display will show 6 levels.

## 3.Water Level Selection

Before washing, consumer can select the water level according to the dirty degree, material or weight of clothes. The detailed usage, consumer can refer to "The relationship between the water level and load."



## Quick start

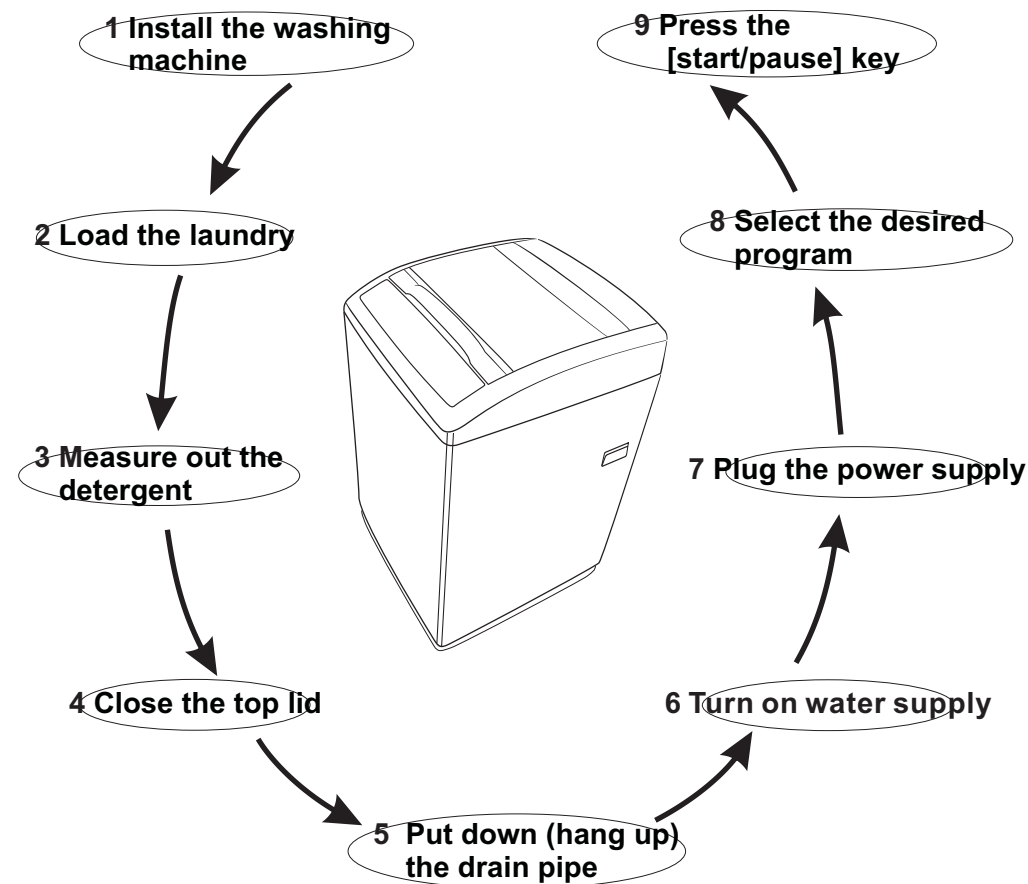

### Main Functions:

#### Preparation:

- 1.Put down the drain pipe;
- 2.Connect the inlet pipe,turn on the tap;
- 3.Put the plug of the power strip into the socket;
- 4.Take out the coins and other things from the pocket,shake off the sediment of the clothes.

### Detailed Steps:

- 1.Press [ON/OFF] button;
- 2.Select the water level according to the washing load;
- 3.Press [Start/Pause] button.

## The main wash

### Program Selection:

1. Press [ON/OFF] button;
2. Select the water level and program;
3. Press [Start/Pause] button.

### When washing process finished:

1. The buzzer will buzz continuously for 6 times and then the power will be automatically cut off;
2. Turn off the water tap.
3. Although the power can be cut off automatically, the power plug must be pull out as well for the safety.

### Alarm function when door opened:

1. When washing or spinning,there will be E3 alarm while consumer open the lid,and if consumer close the lid,the alarm will be released,and to continue to run the previous program which before consumer open the lid.
2. When "Delay" starts,there will be "Delay" E3 alarm while consumer open the lid,and if consumer close the lid,the alarm will be released,and to continue the "Delay"function. But while the machine is running,if consumer open the lid,there will be no alarm.

### Pre-Wash for dirty clothes:

For the stubborn clothes which have soil or heavy smudgy,consumer can select the program of "rinsing","spinning" to pre-wash,after that put the detergent,and then select the full washing programs.

#### Notice:

1. Do not wash the load with the hot water higher than 50°C,to avoid the deformation of plastic parts;
2. If the water level do not reach to the set level,the washing machine will inlet water itself.

### Clothes Washing Skills:

1. While washing the clothes which are easily damaged,consumer can put those clothes into the mesh bag,and then take the washing process;
2. For the big size or easily floated clothes,should be put into the tub first;
3. For the easily pilling clothes,consumer should turn inside out the reverse side clothes, and then take the washing process;
4. While washing the clothes which have strap or zipper,consumer should tie the strap and zip the zipper well.
5. Remove the sediment before washing;
6. For the especially dirty parts,consumer can scrub with detergent first.



! .Close the top lid when machine is running during spin process, otherwise, it will automatically stop working and send out abnormal warning.

! .The washer will not work when the filled water does not reach the set water level.

## Special features

### Delay:

Operation Method:

1. Press [ON/OFF] button;
2. Turn on the tap, put down the drain pipe.
3. Put in the washing load and detergent(Do not sprinkle the detergent on the clothes directly, to avoid the clothes color fading),close the lid;
4. A: While selecting "Soaking", "Jeans", "Baby Clothes" program, press [Delay]button, select the delay time, and then press [Start/Pause] button to start the "delay"program.After "delay" started, the washing machine will take the fuzzy weighting, and then start the "delay"timing.After the fuzzy weighting finished, the washing machine can select the water level within one min, after that, it will come into the formal "delay"status,the buttons can not be operated except [Delay] button,[ON/OFF] button and [child lock] button. B:While selecting"Standard" "Quick", "Blanket", "Delicates", "Drum Clean",press [Delay] button, select the delay time, and then press [Start/Pause] button to start the"delay"program.The buttons can not be operated except [Delay] button, [ON/OFF] button and [child lock]button.

Notice: Long press [Delay] button, every 0.5s will increase 1 hour, and also have a beep once, when after reach to 24 hours, it will return to the initial state.

When "delay" starts, there will be an"delay alarm"if consumer open the lid, and if consumer close the lid, this alarm will be released. But while the machine is running, if consumer open the lid, there will be no alarm. After "delay" starts(do not press "child lock"button), consumer can review the set programs when press [Delay] button again.

### Child Lock:

1. This function is effective only after program starts;
2. Press [Start/Pause]button to start the program, then press [Rinse] & [Program] button at same time to start the child lock function. If consumer wants to close this function, they can re-press [Rinse]&[Program]button at the same time.
3. When "child lock"started,if open the lid during the running process,there will be an alarm. Open the lid within 20s,there will be a "E3"alarm,if close the lid within 20s,the alarm will be released,and continue to run the previous program which before opening the lid.If the lid opened after 20s,the display will show"CL" alarm named "normal failure alarm",the drain valve will be opened.after the water drained lasting for 90s,the drain valve will be closed. During this process,the alarm still can not be released.The normal alarm will be happened every 15 mins,consumer can power off the machine or unplug to release this alarm.

### Water cycle:

After rinsing, keep the last rinsing water,and do not drain.Water cycle function can be selected only under the Jeans program , and need to have the rinsing process (While consumer select the water cycle function,there will be no draining and spinning after the last rinsing,the water will be kept in the drum.)

### Program Pause and restart:

1. When program paused,all load closed,the controller will stop running;
2. When restart the program,the washing machine will run the program before pausing.

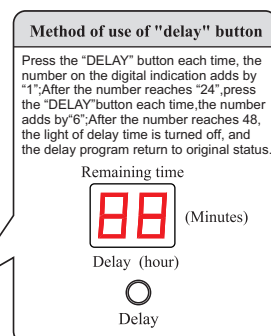

## Special features

### Fuzzy weighting function:

1. Press "ON/OFF" button;
2. Turn on the tap, put down the drain pipe.
3. Put in the washing load and detergent(Do not sprinkle the detergent on the clothes directly, to avoid the clothes' color fading),close the lid;
4. Select "Soaking", "Jeans", "Baby Clothes" program. The washing machine will select the water level automatically according to the load weight.
5. Press [Start/Pause] button to run fuzzy weighting function.

Notice:

1. When there's water in the tub,this function is not available;
2. This function can be only applied under the programs of "Soaking", "Jeans", "Baby Clothes";
3. Before press [Start/Pause] button,if consumer selected the water level,there will be no fuzzy weighting function;
4. After press [Start/Pause] button,the washing machine will run the fuzzy weighting function. Consumer can also select the water level to set the water level as needed.

### Self Power off function:

1. After the program finished,the washing machine will power off automatically;
2. If consumer selected the program but not press the [Start/Pause] button,the washing machine will power off automatically after 10 mins;
3. When alarm happened and was not released,the washing machine will power off after 1 hour;
4. When consumer pressed the [Start/Pause] button during the running process,and forgot to re-press it to continue the program,the washing machine will power off after 1 hour.

### Unbalance Control:

1. During the spin process,and under the condition of safety switch connected,if the sudden break happened,the washing machine will come into the unbalance adjustment situation;
2. While coming into the unbalance adjustment process,the rinsing LED flashed,inlet the water to reach to the set level,adjust the clothes' status,drain after finished rinsing,and return to the normal spinning process.If it is not effective after 3 times' adjustment,there will be an alarm.

### Power failure memory function

If the power supply becomes off suddenly during operation , the machine remembers the current operation state . When power is on ,the machine returns to former operation state automatically.



## About the procedure of full automatic wash program

### Standard:

Standard fabric washing program,suitable to wash ramie cotton fabric.Wash for once,rinsing for twice,the spin time is a little long.

### Quick:

Suitable to wash light stained clothes and clothes in summer.

### Blanket:

Suitable to wash big size load such as curtain/bed sheet etc.,There's 15mins additional movement soaking time during the washing process.(Movement soak can make the effect of soaking much better.)

### Delicates:

Mid/High/Low water level selection,the tempo is soft,slow washing and spinning speed,to make the lightest wear and deformation.

### Soaking:

Suitable to wash more dirtier clothes,there's 30 mins additional soaking time during the washing process.

### Jeans:

Suitable to wash heavy stained/wearable clothes.

### Baby Clothes:

Increase the rinsing times,to reduce the detergent residue on the clothes.Suitable to wash children's clothes.

### Drum Clean:

By the intermittent spinning,clean the dirt of inner & outer tub and impeller.







## About the procedure of full automatic wash program

Program	Wash time	Rinse times	Water level	Spin time	Total time
Jeans	15 minutes	2 times	water level for fuzzy	6 minutes	48 minutes
Quick	3 minutes	1 times	2	1 minutes	10 minutes
Blanket	Soak 15 minutes Wash 15 minutes	3 times	7	6 minutes	74 minutes
Delicates	9 minutes	2 times	4	2 minutes	38 minutes
Soaking	Soak 30 minutes Wash 15 minutes	2 times	water level for fuzzy	6 minutes	78 minutes
Standard	Soak 12 minutes Wash 10 minutes	1 times	7	14 minutes	62 minutes
Baby Clothes	12 minutes	3 times	water level for fuzzy	6 minutes	56 minutes
Drum Clean	6 minutes	1 times	8	3 minutes	28 minutes

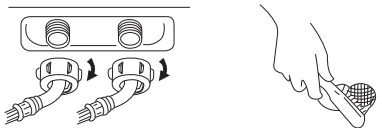
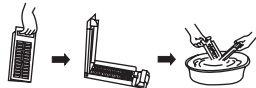
Note: The time required will also vary with water pressures of intake pipe, different clothes textures and different water drain conditions.

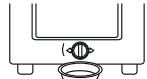
During Standard washing program ,it is identified as Efficiency Program.

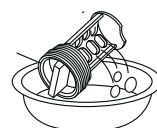
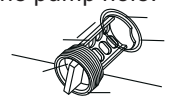
## Cleaning and Maintenance of the washing machine

End of program		Maintenance
<ul style="list-style-type: none"> <li>The washing machine will send off the sound of “dou-dou” at the end of any program operation to remind you to take out the laundry or operate it again.</li> <li>After the sound, the washing machine returns to its power-off state with no display and all lights off.</li> <li>Please shut off the tap, pull out the plug when not in use to avoid water leakage or the fire accidents.</li> </ul>		Use gentle clothing to wipe off the water and dirt on the surface each time after using the washing machine. Detergent, propellant and other chemicals are not allowed to use so as to avoid any damage to the plastic accessories. 
Clean the water inlet		Clean Of the filter
After long time use, the water inlet mesh bag may be blocked with smudginess, and should be cleaned according to the following steps: 1. Switch on the power, followed by shutting off the tap. 2. Let the washer works for 5 seconds so that water flows into the tub through the water inlet hose. then turn off the power. 3. Unload the water inlet hose and clean the mesh bag, then restore the water inlet assembly. 		After using the washing machine for a period , please clean it according to the following steps : 1 .Take out the lint filter . 2 Open the filter and wash it clean in the water . 3 .Restore it and fix it .  <p>(only for magic filter)</p>
		After using the washing machine for a period, please clean it according to the following steps: 1. Take off the lint filter. 2. Turn over the mesh bag and wash it clean in the water. 3. Restore it and fix it.  <p>(only for normal filter)</p>
Clean the lint filter in the drain pump (only for having drain filter)		
1. Drain the water out of the pump, under which use a container to collect.	2. Loosen the pump cover anticlockwise.	3. Take out the lint filter.
		
4. Clean the filter.	5. Restore it and adjust the convex place to align at the pump hole.	6. Tighten the pump cover clockwise.
		

Note: If the drain filter is not cleaned at proper time (every 10 times of use), Drain problem could be caused.

## Identify usual trouble of washer

When the washer is in trouble, please contact local service office or the sales service department of our company and the customer should not dismantle the machine without permission.

If the washer can not work normally, or appear abnormality or alarms, please check and correct as follows.

### List of faults and inspection

Faults	Inspection Items
No water flows in	<ul style="list-style-type: none"> <li>If the power is off or the fuse is burned out.</li> <li>If the water supply is cut off or the water pressure is too low.</li> <li>If the inlet hose is properly connected and the water tap is opened.</li> <li>If the filtering screen of inlet valve is blocked by dirt.</li> <li>If the coil of inlet valve is damaged. (The slight electromagnetic sound is normal phenomenon when the inlet valve is switched on)</li> <li>If the "Start / Pause" button is pressed after the power switch is pressed.</li> </ul>
No washing	<ul style="list-style-type: none"> <li>If the power is off or the fuse is burned out.</li> <li>If the power supply voltage is too low.</li> <li>If the water amount reaches to the required water level. (The washer will not work if the water amount does not reach the required water level)</li> <li>If it is set to "Delay" washing mode. (It will only start to work until the reservation time reached)</li> </ul>
Abnormal draining	<ul style="list-style-type: none"> <li>If the water drain hose is placed very high.</li> <li>If the end of water drain hose is sealed in pond.</li> <li>If the internal rubber ring of drain valve is blocked by dirt.</li> </ul>
Abnormal spin	<ul style="list-style-type: none"> <li>If the door lid is closed.</li> <li>If all clothing piled largely at one side of barrel or the clothing is excessively placed.</li> <li>If the washer is not placed in stable condition or it is placed in inclination state. (The ground is not flat).</li> <li>If the motor belt is loosened.</li> </ul>

Note: During the de spin process, if washing are piled at one side of the spin barrel, it will cause unbalance of spin barrel resulting in striking. At this moment, the computer inside the washer will feel this unbalance phenomenon and will automatically correct it ( fill in water Washing ). However, if unbalance situation is not removed after continuous three corrections, which means the computer auto-correction can not resolve the problem. Then the user has to manually and evenly place the clothing inside the barrel to solve the problem.

# Malfunction display and solutions

When the washer is in trouble, please contact local service office or the sales service department of our company and the customer should not dismantle the machine without permission.

If the washer can not work normally, and the abnormal indication is shown in the digital display window or the machine alarms, please check and correct as follows.

Falut	Cause of fault	Indication	Alarm of the buzzing sound	Stopping alarm
Alarm for water inlet	Water injection for about 30 mins, but do not reach preset water level.	“E1”flares	The buzzer goes on buzzing for 10 seconds. If the fault is not solved, buzzes again for 10 seconds in every 15minutes.	Open the lid to deal with faults, then close the lid to stop the alarm.
Drain Alarm	Drain off water 10 mins not arrive at empty water level.	“E2”flares		
Alarm for opening lid	Open the lid during washing or spinning process. Open the lid after start the delay time.	“E3”flares		
Imbalance Alarm	Checked imbalance for the third time.	“E4”flares		

Note:The program which has E4 alarm when shocked in the first time is “Drum Clean”.

## Technical specifications

Model	BWM55
Size	530X542X925(mm)
Rated input power	340W
Rated voltage	240V~
Rated frequency	50Hz
Weight of the product	32kg
Rated capacity of wash and spinning	5.5kg (dry clothes)
Maximum water pressure permitted in the water inlet	0.6Mpa
Minimum water pressure permitted in the water inlet	0.1Mpa